

140 Degree CCPM Control

R50N935-SS

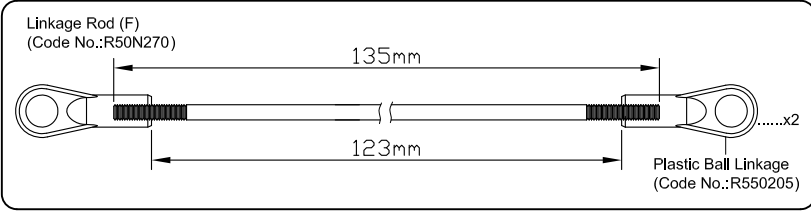

R50N926-SS

- Cap Screw M2x6mmx6
- Cap Screw M2x4mmx2
- Linkage ball 4.75 x5mmx6
- Set Screw Flat M3x3mmx4
- Shim Washer Brass Ø3xØ5x0.5mmx1
- Flat Washer Ø2xØ4x0.5mmx2
- Ball Bearing 3x6x2.5mmx2

R50N935-SS

- Cap Screw M3x25mmx2
- Cap Screw M2x6mmx3
- Linkage ball 4.75 x5mmx3
- Shim Washer Brass Ø3xØ5x0.5mmx2
- Flat Washer Ø3xØ7x0.8mmx4
- Ball Bearing 3x6x2.5mmx2

Elevator Bell Crank Assembly

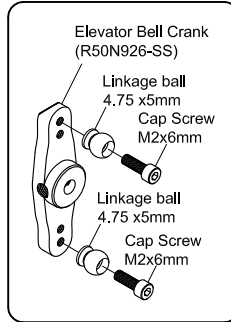

Aileron Bell Crank 2 CNC Assembly...x2

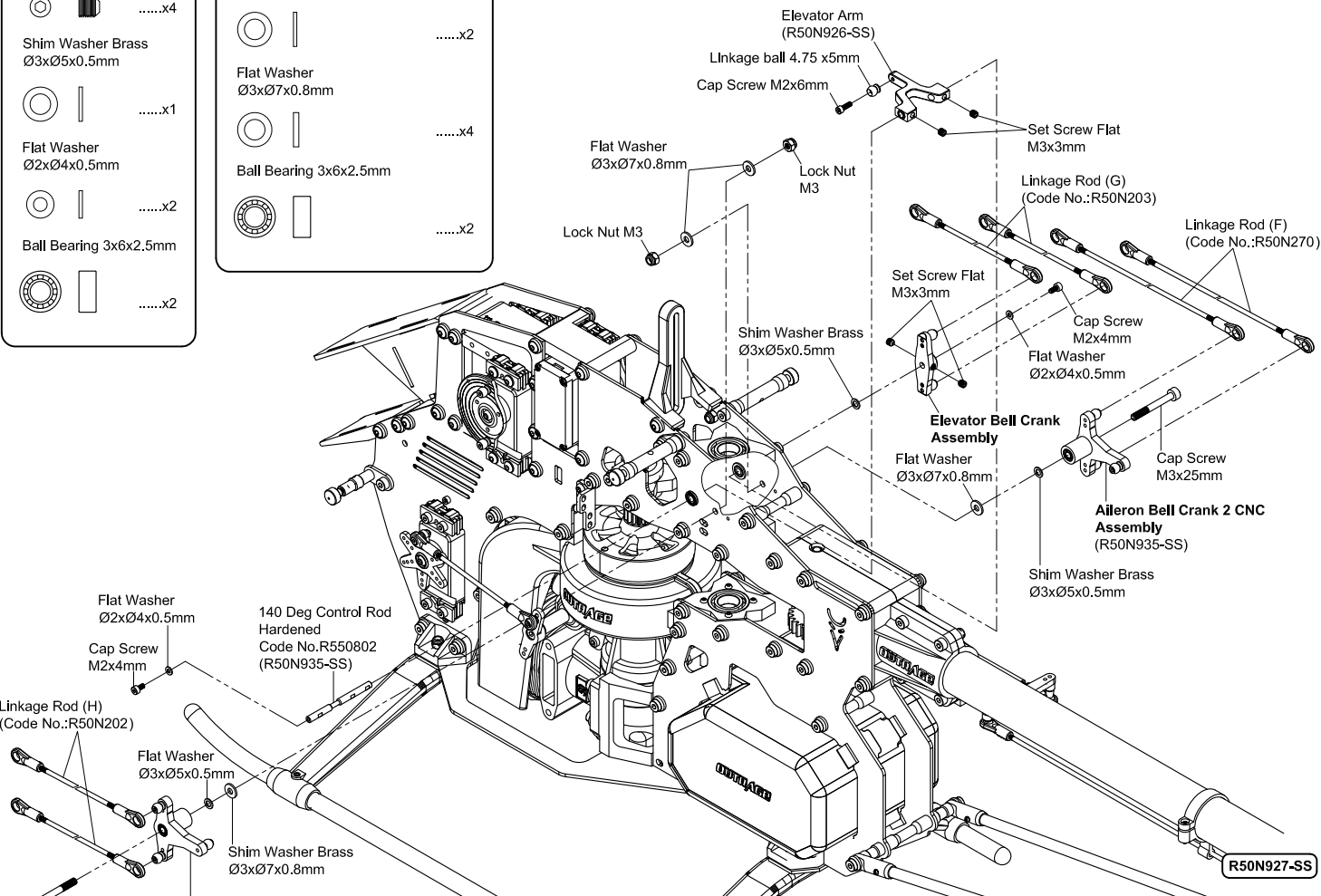
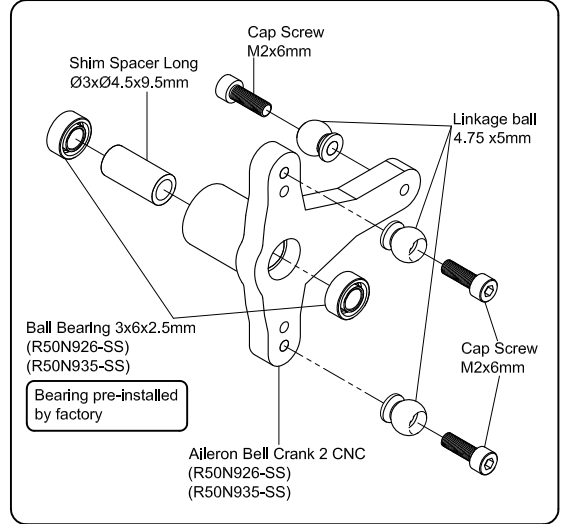

(!) Caution:

Use medium strength thread lock compound on all screws

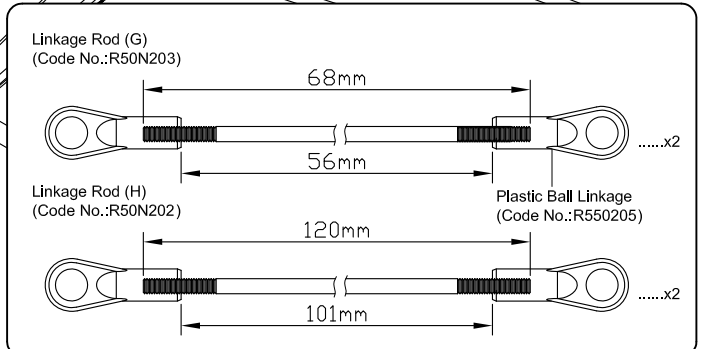

140 Degree CCPM Control

R50N924-SS

Cap Screw M3x20mm Shouldered

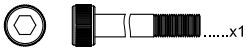

Lock Nut M3

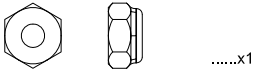

Shim Washer 10x13x1mm

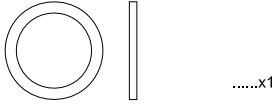

R50N927-SS

Swash Linkage Rod
(Code No.:R550404)

Plastic Ball Linkage
(Code No.:R550205)

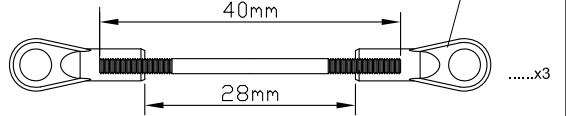

Note: Install mast screw in lower hole

Cap Screw Shouldered
M3x10mm

Main Shaft Mast Collar
(R50N908-SS)

R50N908-SS

Cap Screw M3x10mm Shouldered



Shim Washer
10x13x1mm

Cap Screw M3 x20mm
Shouldered

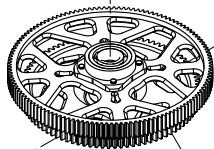

Oneway Hub and Drive
Assembly
(R50N924-SS)

Lock Nut M3

(!) Caution:

Use medium strength thread
lock compound on all screws



Note: After the main gear is attached to the main shaft it is important to set the correct gear mesh and align the engine with the clutch bell by following these procedures:

1. Loosen the four bolts holding the motor mount to the frames.
2. Loosen three bolts on base frame holding engine mount.
3. Loosen the four bolts holding the pinion bearing block.
4. Inset one thickness of paper (standard printer paper) between the pinion gear and the main gear, and then push the pinion and pinion bearing block hard against the main gear. Using Loctite, tighten the pinion bearing block screws.
5. Now remove the piece of paper. There should be a very slight amount of backlash in the gears.
6. Now adjust the position of the engine so as the bottom of the clutch assembly is parallel with the bottom of the clutch bell. Confirm also that the engine start shaft rotates freely.
7. Using Loctite, fully tighten the engine mount bolts.

140 Degree CCPM Control

Head System

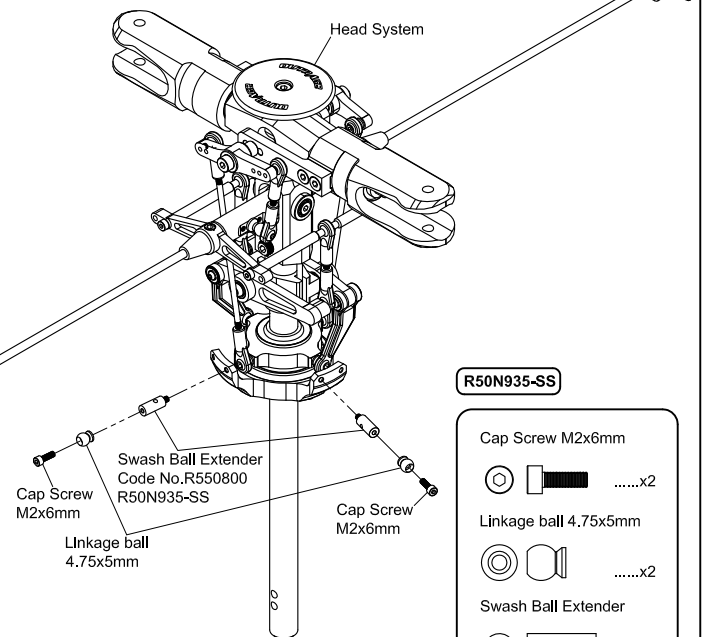

R50N935-SS

Cap Screw M2x6mm



Linkage ball 4.75x5mm



Swash Ball Extender

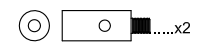

Cap Screw
M2x6mm

Swash Ball Extender
Code No.:R550800
R50N935-SS

Linkage ball
4.75x5mm

Cap Screw
M2x6mm