

KALT HELICOPTER SPACE BARON

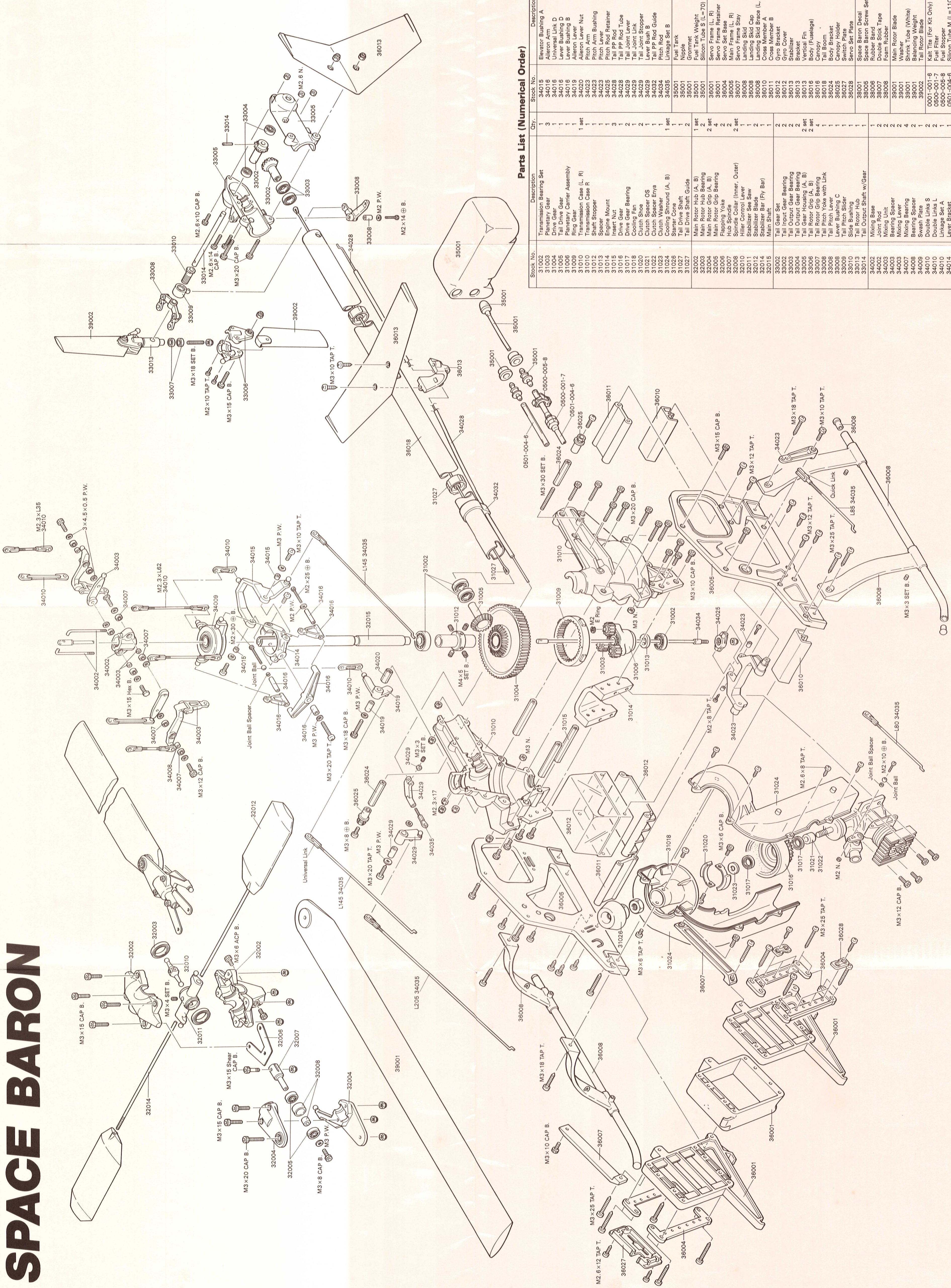

Parts List (Numerical Order)

Stock No.	Description	Stock No.	Description	Qty.
31002	Transmission Bearing Set	34015	Elevator Bushing A	2
31003	Planetary Gear	34016	Aileron Arm	1
31004	Ring Gear	34017	Universal Link D	2
31005	Planetary Carrier Assembly	34018	Universal Link C	1
31006	Planetary Carrier Assembly	34019	Lever Bushing B	1
31007	Ring Gear	34020	Aileron Lever	1
31008	Transmission Case (L, R)	34021	Aileron Lever Nut	1
31009	Transmission Case R	34022	Pitch Arm	2
31010	Shaft Stopper	34023	Pitch Arm Bushing	2
31011	Space Mount	34024	Pitch Lever	1
31012	Space Mount	34025	Pitch Lever Retainer	1
31013	Insert Nut	34026	Tail PP Rod	1
31014	Drive Gear	34027	Tail PP Rod Tube	1
31015	Drive Gear	34028	Tail Joint Link	1
31016	Drive Gear	34029	Tail Joint Link	1
31017	Cooling Fan	34030	Tail Joint Stopper	1
31018	Clutch Shoe	34031	Tail Joint Stopper	1
31019	Clutch Shoe OS	34032	Tail PP Guide	1
31020	Clutch Washer	34033	Pitch Rod	1
31021	Clutch Washer	34034	Linkage Set B	1
31022	Cooling Shroud (A, B)	35001	Fuel Tank	1
31023	Starter Cone	35001	Nipple	2
31024	Starter Cone	35001	Grommet	2
31025	Tail Drive Shaft	35001	Fuel Tank Weight	1
31026	Tail Drive Shaft Guide	35001	Silicon Tube S (L=70)	1
32002	Main Rotor Hub (A, B)	35001	Silicon Tube S (L=70)	1
32003	Main Rotor Hub (A, B)	35001	Silicon Tube S (L=70)	1
32004	Main Rotor Hub (A, B)	35001	Silicon Tube S (L=70)	1
32005	Main Rotor Hub (A, B)	35001	Silicon Tube S (L=70)	1
32006	Hub Spindle	35001	Silicon Tube S (L=70)	1
32007	Hub Spindle	35001	Silicon Tube S (L=70)	1
32008	Hub Spindle	35001	Silicon Tube S (L=70)	1
32009	Hub Spindle	35001	Silicon Tube S (L=70)	1
32010	Hub Spindle	35001	Silicon Tube S (L=70)	1
32011	Hub Spindle	35001	Silicon Tube S (L=70)	1
32012	Hub Spindle	35001	Silicon Tube S (L=70)	1
32013	Hub Spindle	35001	Silicon Tube S (L=70)	1
32014	Hub Spindle	35001	Silicon Tube S (L=70)	1
32015	Hub Spindle	35001	Silicon Tube S (L=70)	1
33002	Tail Gear Set	35001	Silicon Tube S (L=70)	1
33003	Tail Input Gear Bearing	35001	Silicon Tube S (L=70)	1
33004	Tail Output Gear Bearing	35001	Silicon Tube S (L=70)	1
33005	Tail Gear Housing (A, B)	35001	Silicon Tube S (L=70)	1
33006	Tail Gear Housing (A, B)	35001	Silicon Tube S (L=70)	1
33007	Tail Rotor Grip (A, B)	35001	Silicon Tube S (L=70)	1
33008	Tail Rotor Grip (A, B)	35001	Silicon Tube S (L=70)	1
33009	Tail Pitch Yoke with Link	35001	Silicon Tube S (L=70)	1
33010	Tail Pitch Lever	35001	Silicon Tube S (L=70)	1
33011	Lever Bushing C	35001	Silicon Tube S (L=70)	1
33012	Tail Pitch Slider	35001	Silicon Tube S (L=70)	1
33013	Slide Bushing	35001	Silicon Tube S (L=70)	1
33014	Tail Output Shaft w/Gear	35001	Silicon Tube S (L=70)	1
34002	Mixing Base	35001	Silicon Tube S (L=70)	1
34003	Joint Rod	35001	Silicon Tube S (L=70)	1
34004	Mixing Unit	35001	Silicon Tube S (L=70)	1
34005	Bearing Spacer	35001	Silicon Tube S (L=70)	1
34006	Mixing Lever	35001	Silicon Tube S (L=70)	1
34007	Mixing Bearing	35001	Silicon Tube S (L=70)	1
34008	Mixing Spacer	35001	Silicon Tube S (L=70)	1
34009	Swash Plate	35001	Silicon Tube S (L=70)	1
34010	Double Link S	35001	Silicon Tube S (L=70)	1
34011	Double Link L	35001	Silicon Tube S (L=70)	1
34012	Linkage Set A	35001	Silicon Tube S (L=70)	1
34013	Layer Bracket	35001	Silicon Tube S (L=70)	1
34014	Elevator Lever	35001	Silicon Tube S (L=70)	1
34015	Elevator Lever	35001	Silicon Tube S (L=70)	1