

Abb. 1



Abb. 2



Abb. 4

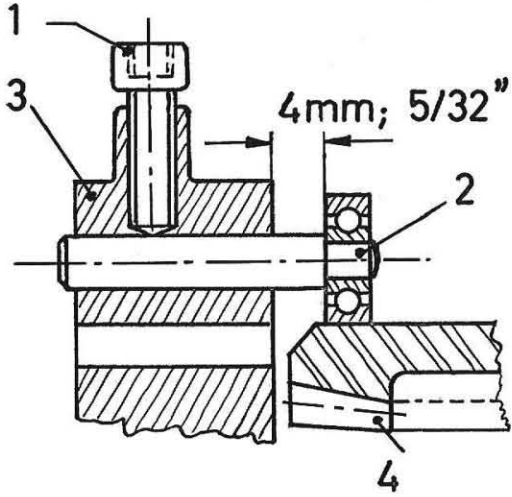

Abb. 5

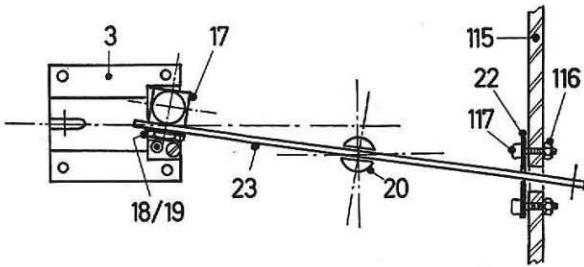

Abb. 6

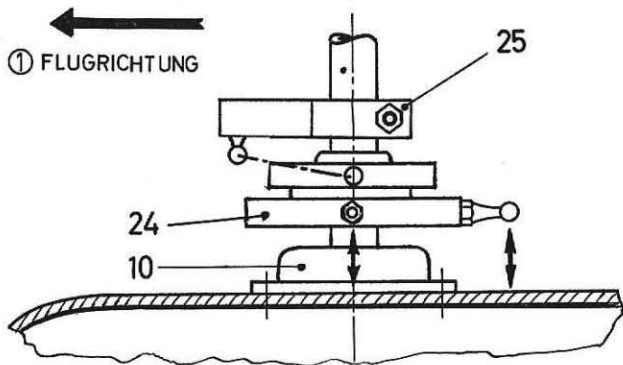

Abb. 3 Das eingebaute Antriebsaggregat.  
Ansicht von Rumpf-Unterseite.

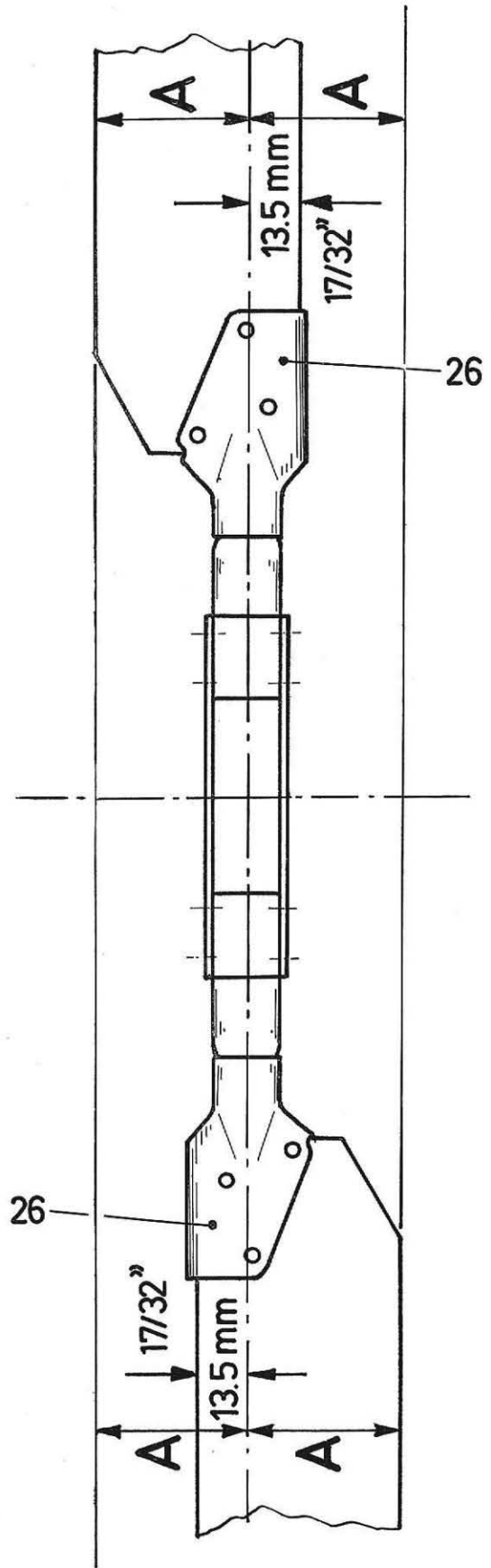

Abb. 7

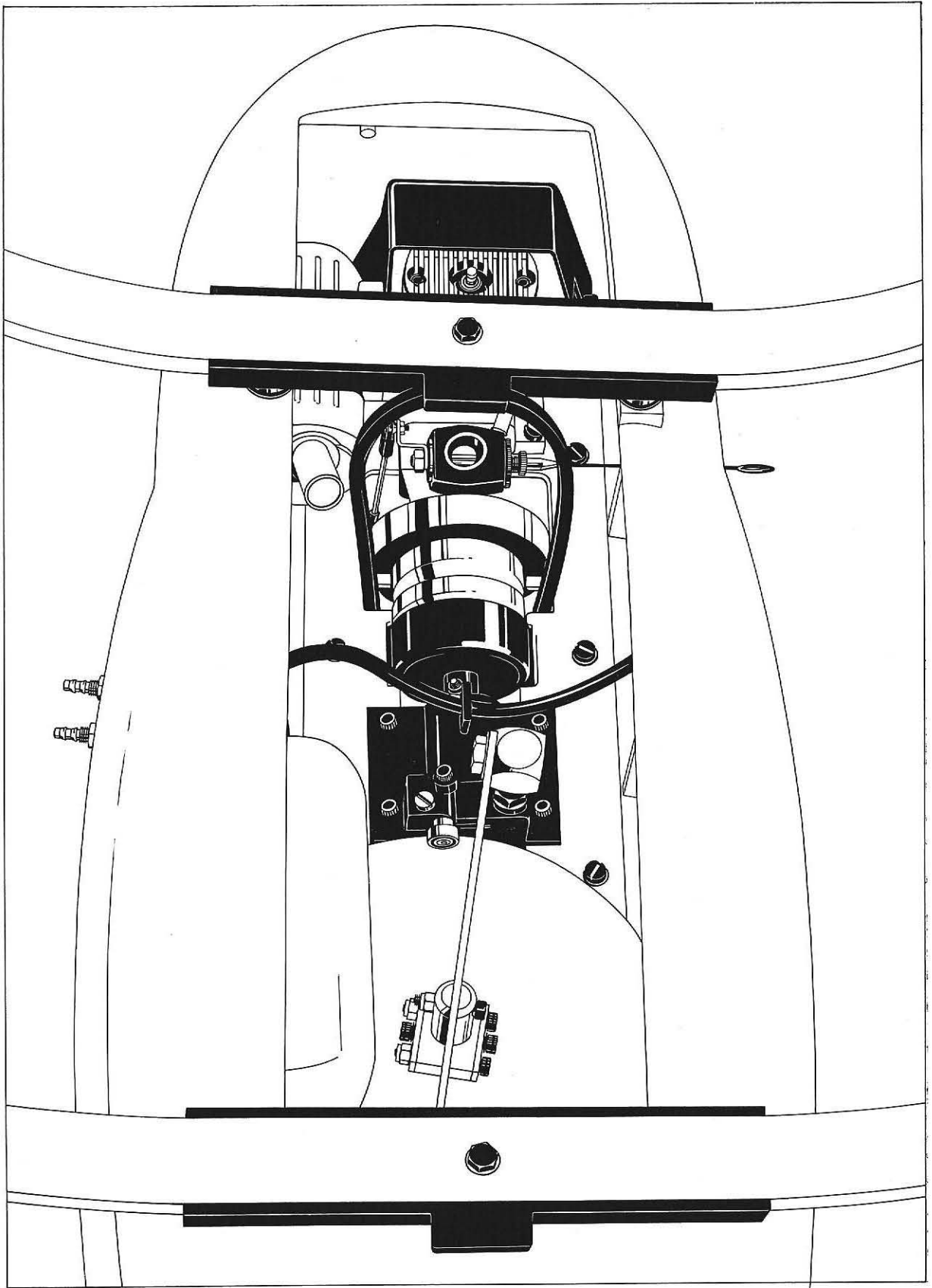

Abb. 10

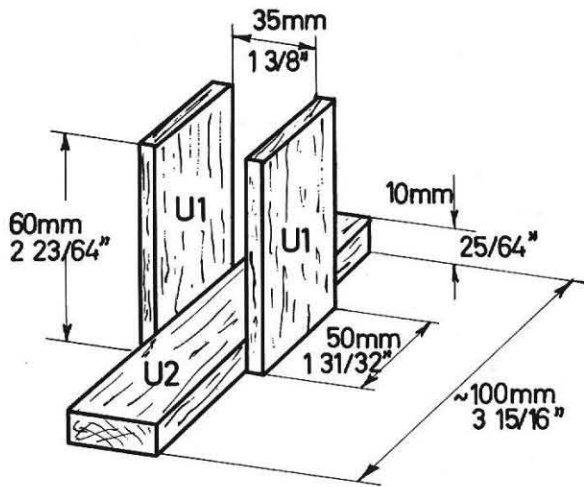

① von oben gesehen

Abb. 8

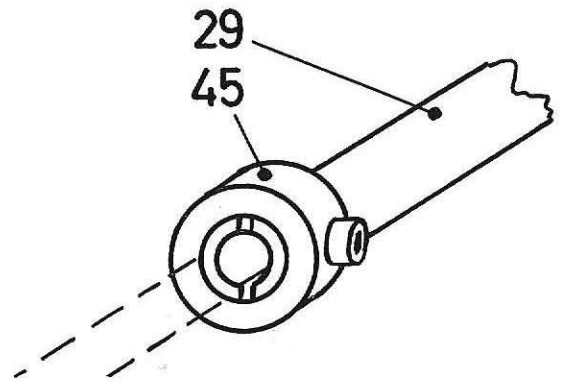
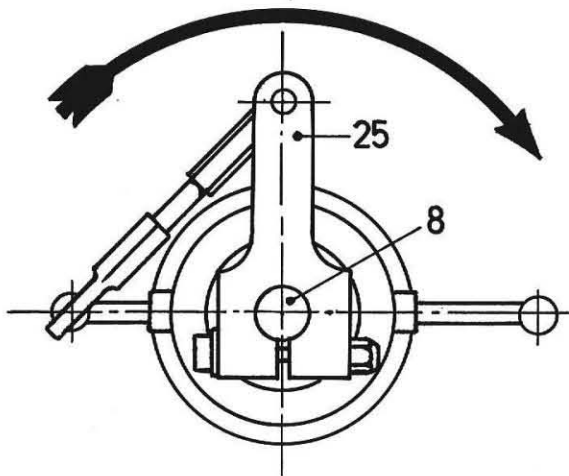

Abb. 15



Abb. 16

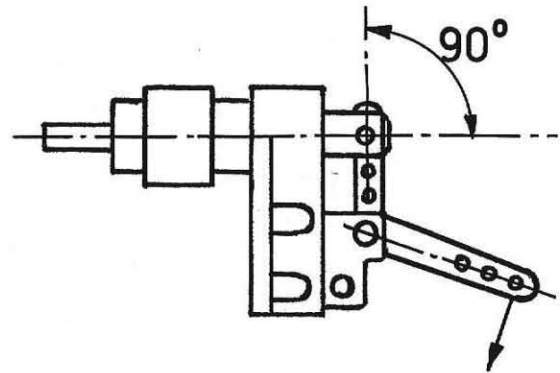

Abb. 9

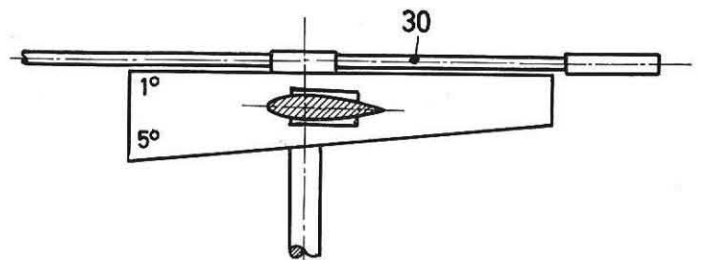

Abb. 17

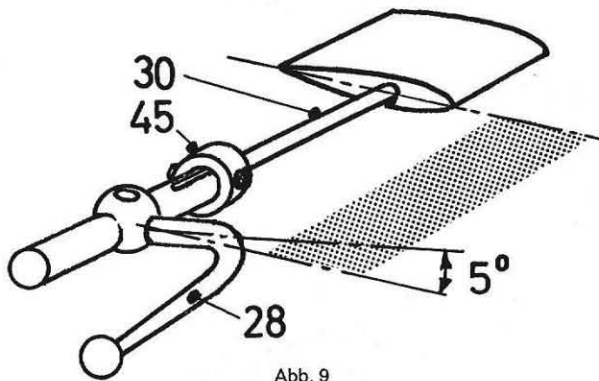

**Graupner**

zu Bestell-Nr.  
80

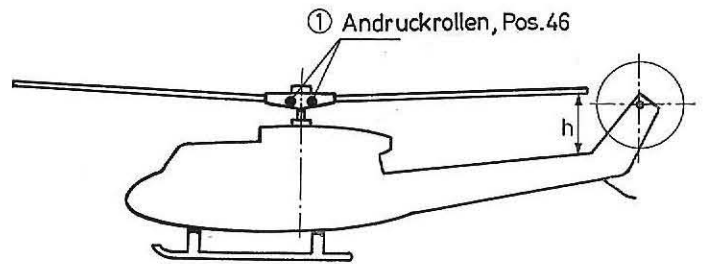
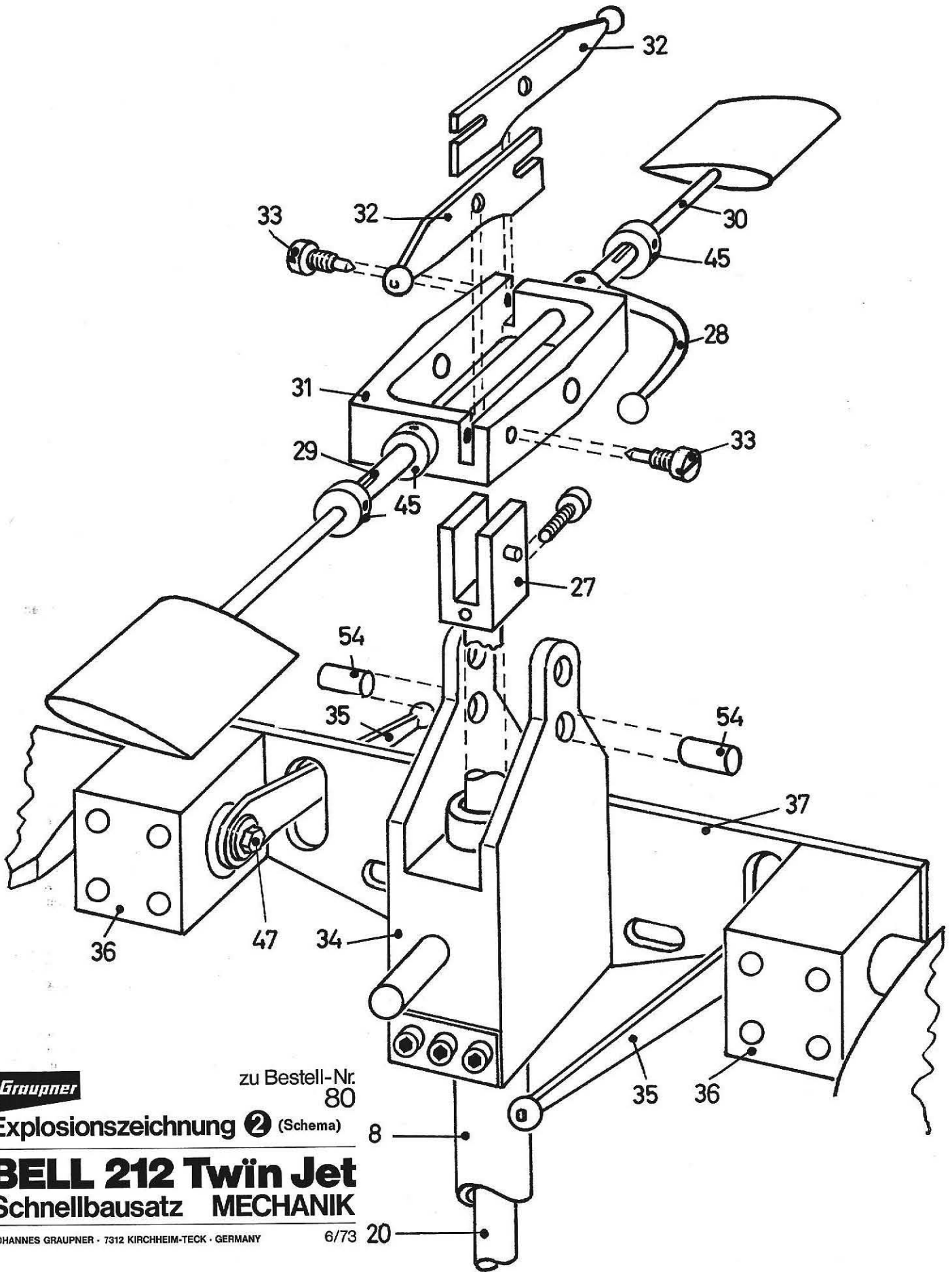
Explosionszeichnung 2 (Schema)

**BELL 212 Twin Jet**  
Schnellbausatz MECHANIK

JOHANNES GRAUPNER · 7312 KIRCHHEIM-TECK · GERMANY

6/73 20

① Ansicht von der Unterseite des Rumpfes

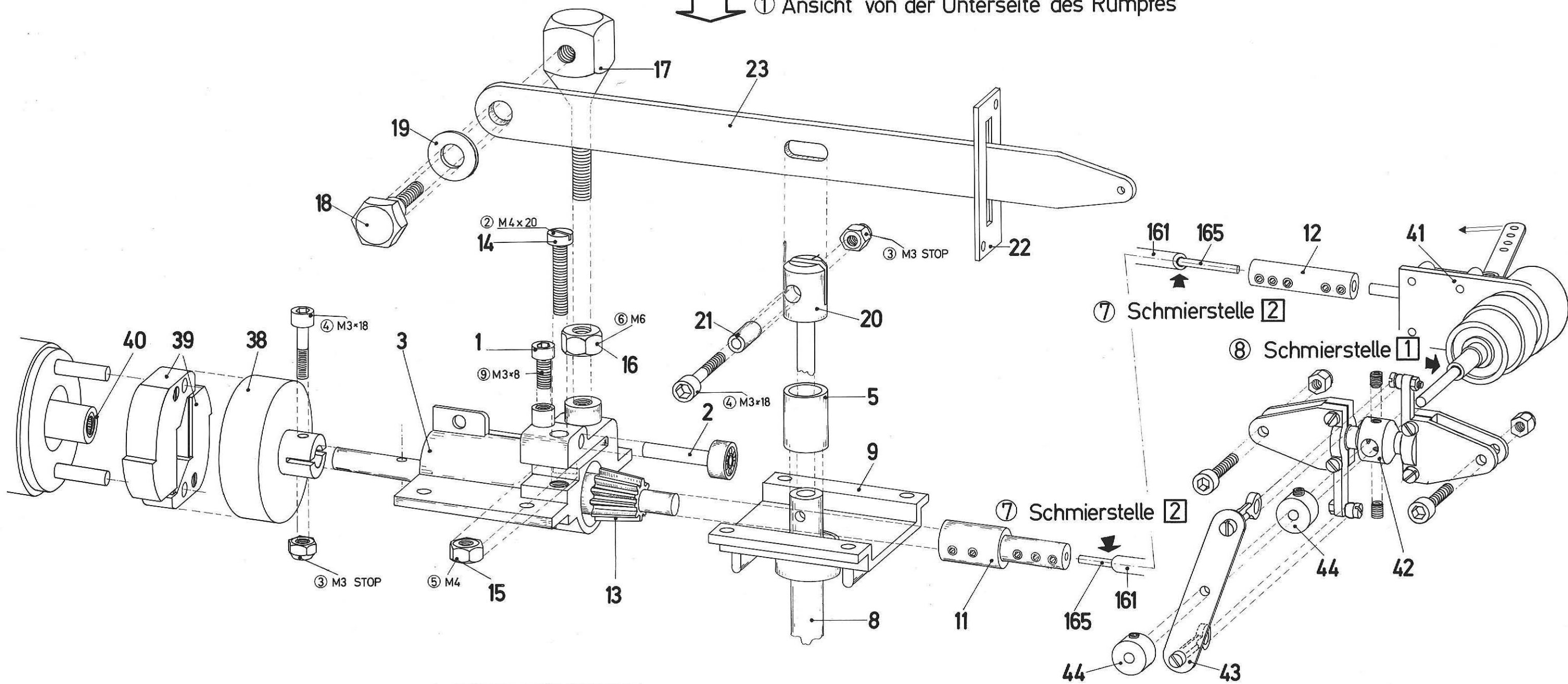

Die Texte sind mit eingekreisten Nummern versehen. Diese Numerierung erleichtert das Auffinden der zugeordneten fremdsprachigen Texte in der jeweiligen Anleitung.

The texts are provided with encircled numbers. This numbering facilitates the locating of the adjoined texts in the respective instructions.

Les textes ont des numéros encadrés. Ce numérotage facilite de trouver les textes des langues étrangères adjoints dans les instructions respectives.

Le testi sono provvisti di numeri accerchiati. Questa numerazione facilita di trovare il testo dell'istruzione rispettiva in lingua straniera.



zu Bestell-Nr. 80

Explosionszeichnung ①

**BELL 212 Twin Jet**  
Schnellbausatz MECHANIK



Abb. 11 und 12 Der Rotorkopf in verschiedenen Ansichten.



Abb. 13 und 14 Der Heckrotor in zwei Ansichten.

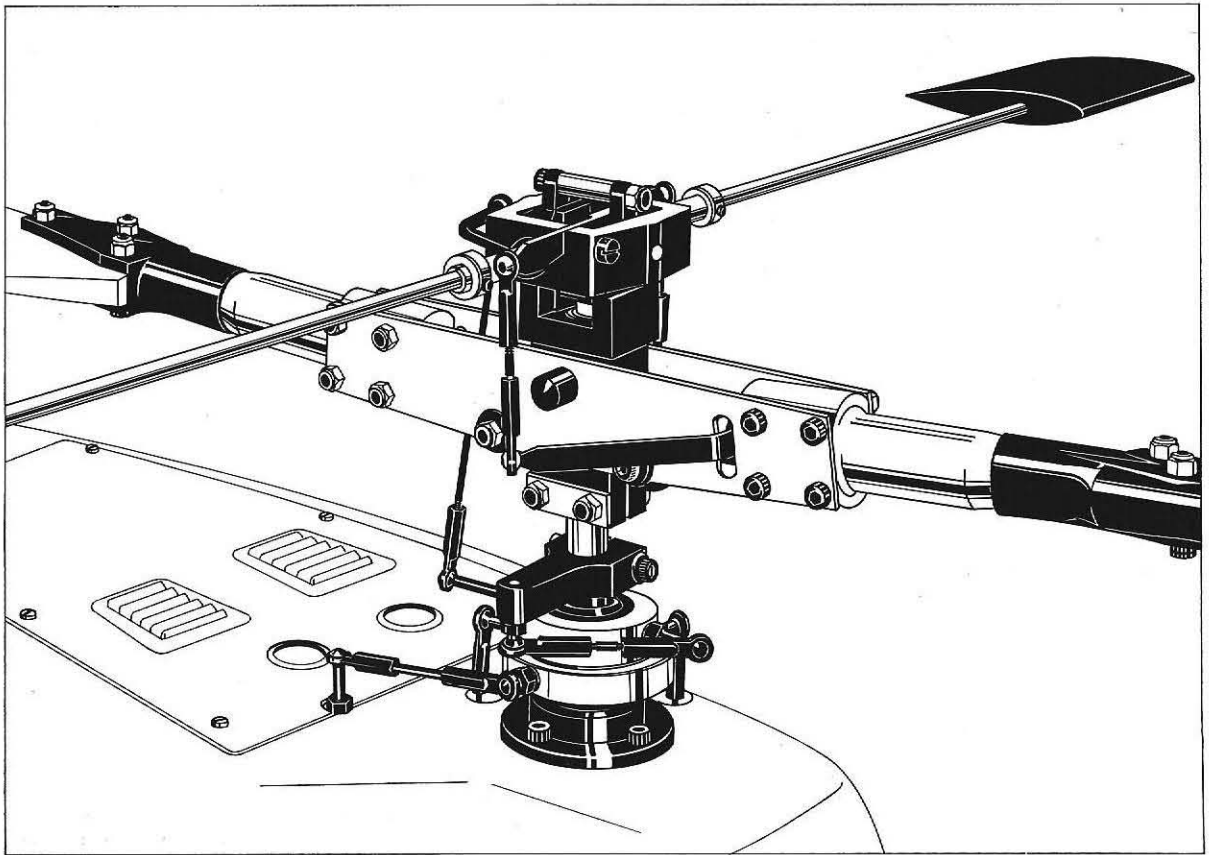
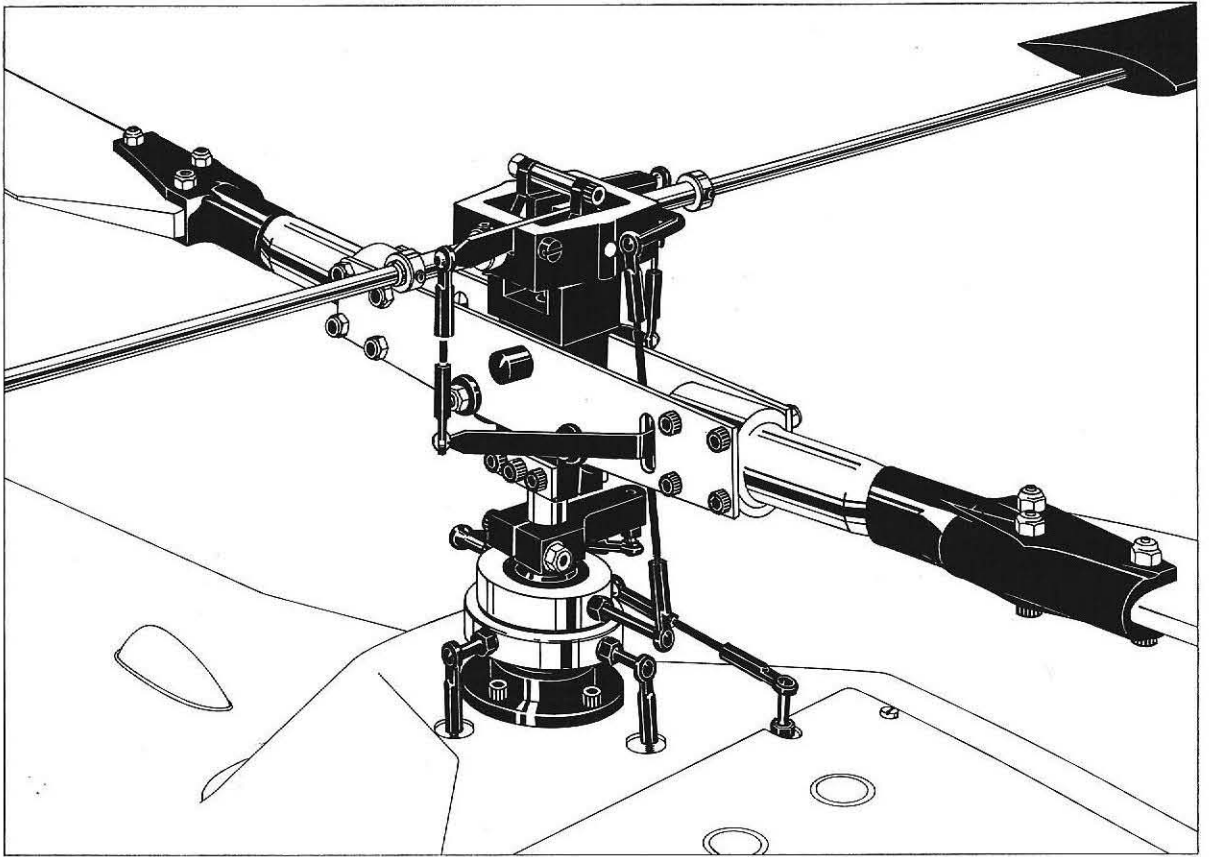

### 1 Halbstarrer Rotorkopf

schwingungstechnisch das Günstigste für Modellhubschrauber

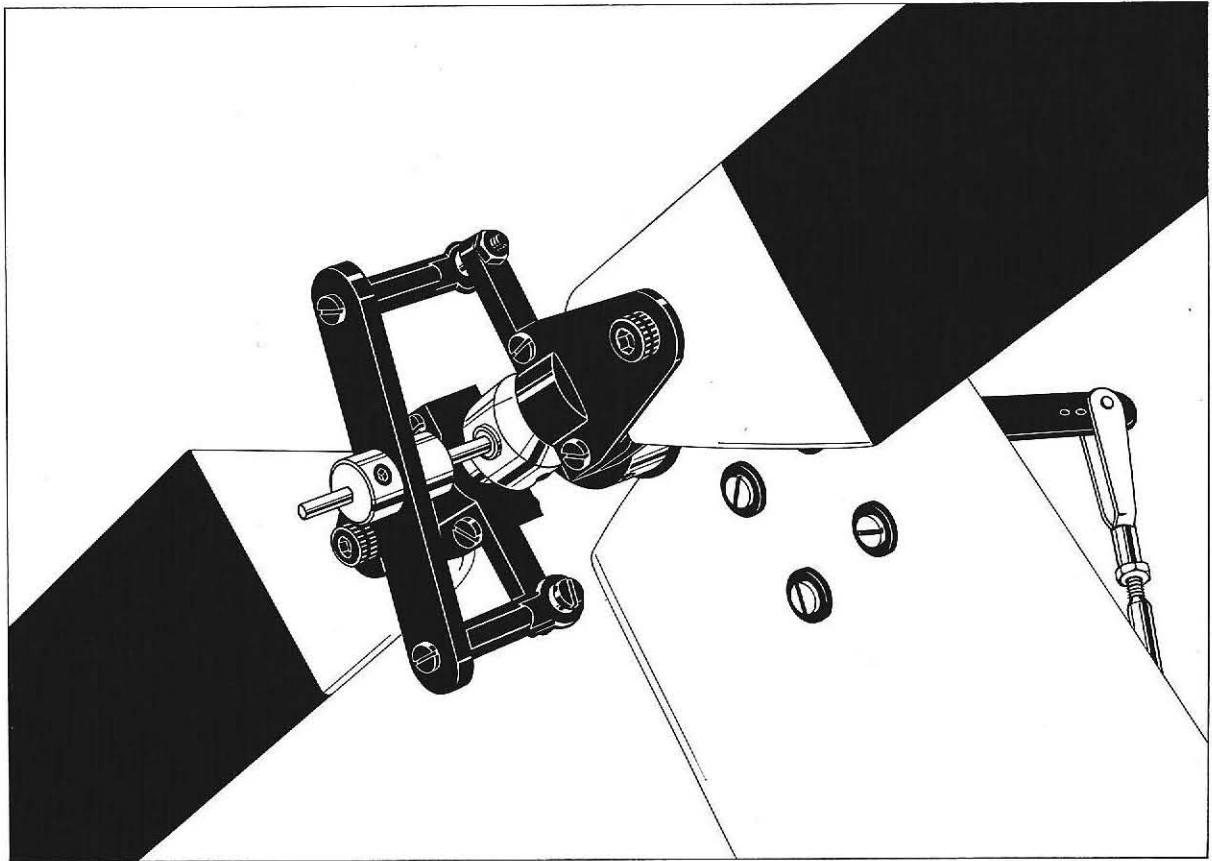
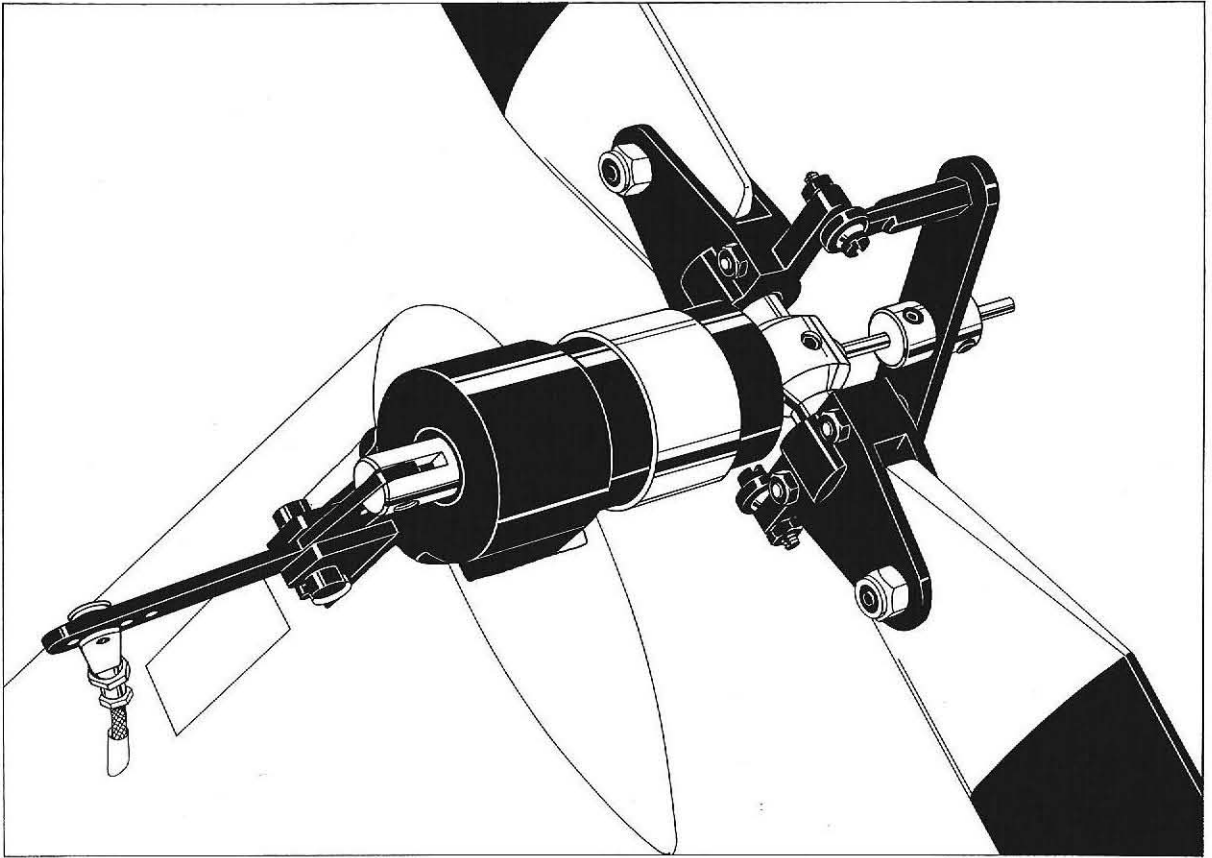
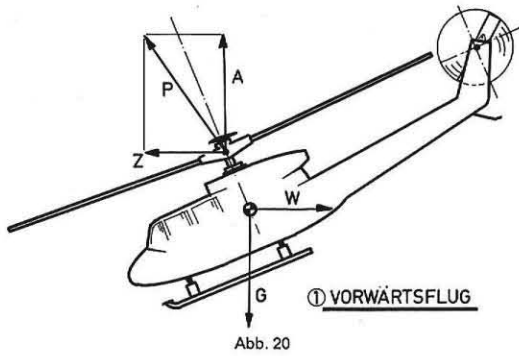
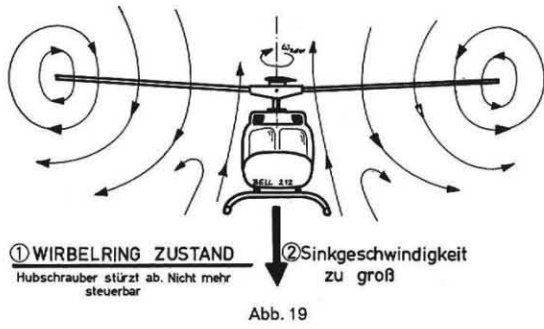
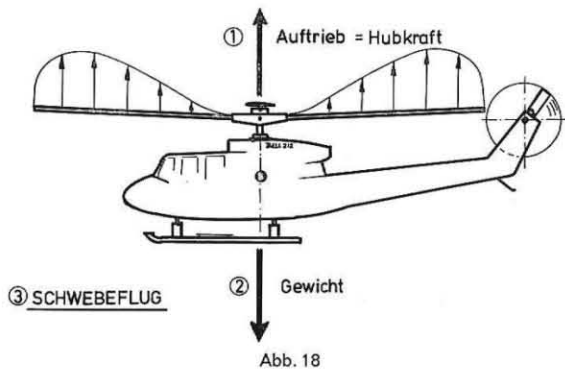
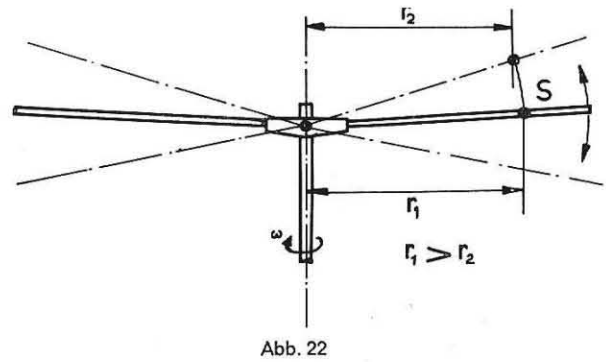
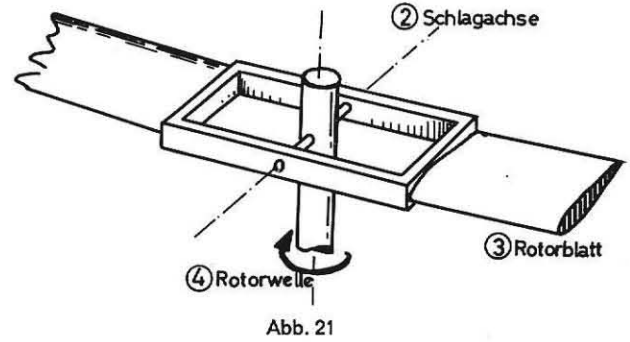

### 1 Modell Bell 212 Twin Jet

